

- NOTES:
- MATERIAL:
 - HOUSING: THERMOPLASTIC, HIGH TEMP., UL94V-0; COLOR:NATURAL.
 - CONTACT: COPPER ALLOY
 - FITTING NAIL: COPPER ALLOY
 - ACTUATOR : THERMOPLASTIC, HIGH TEMP., UL94 V-0; COLOR:BLACK.
 - FINISH:
 - CONTACT:
 - 50u" MIN. NICKEL PLATING OVERALL.
 - M:3u" MIN. GOLD PLATING ON CONTACT
 - GOLD FLASH PLATING ON SOLDER TAIL.
 - P:3u" MIN. GOLD PLATING ON CONTACT
 - 1u" MIN. GOLD FLASH ON SOLDER TAIL.
 - FITTING NAIL:
 - 50u" MIN. NICKEL PLATING OVERALL.
 - 80u" MIN. MATT TIN ON SOLDER TAIL
 - SPEC. PLS. REFER TO PS-51612-XXXX-XXX
 - PACKAGE PLS. REFER TO 51612-XXXX-02-TRP
 - PART NUMBER

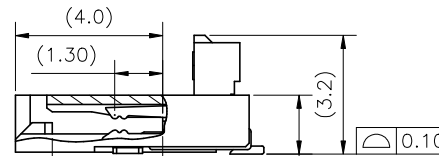
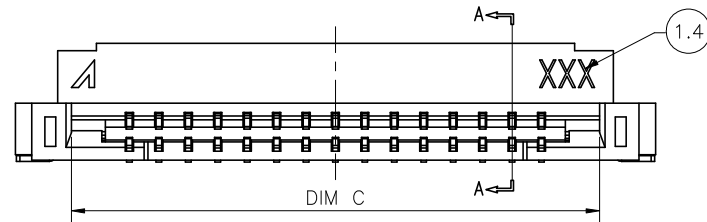

CKTS	XXX	PACKAGE
PACKING	001	51612-XXXXCR-02
O: T&R		

M: 3u" MIN. GOLD PLATING ON CONTACT
 GOLD FLASH PLATING ON SOLDER TAIL
 P: 3u" MIN. GOLD PLATING ON CONTACT
 1u" MIN. GOLD PLATING ON SOLDER TAIL

SECTION A-A

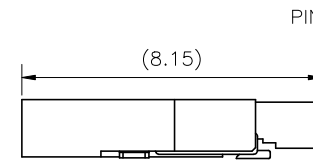

(ACTUATOR CLOSED)

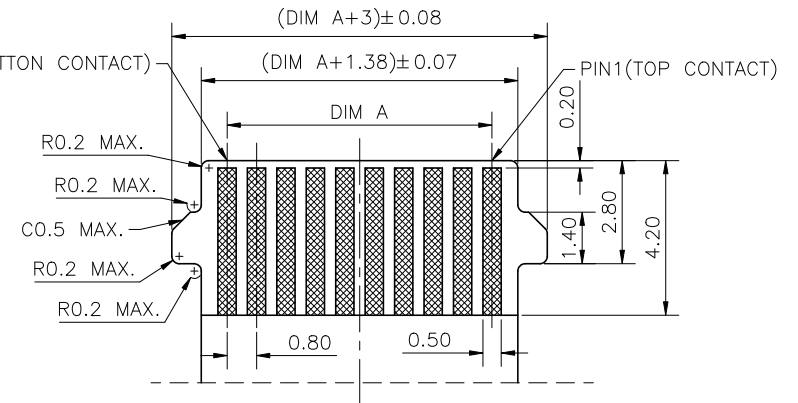

RECOMMENDED FPC/FFC DIMENSIONS
 GENERAL TOLERANCE ±0.05
 (THICKNESS:0.3±0.03)

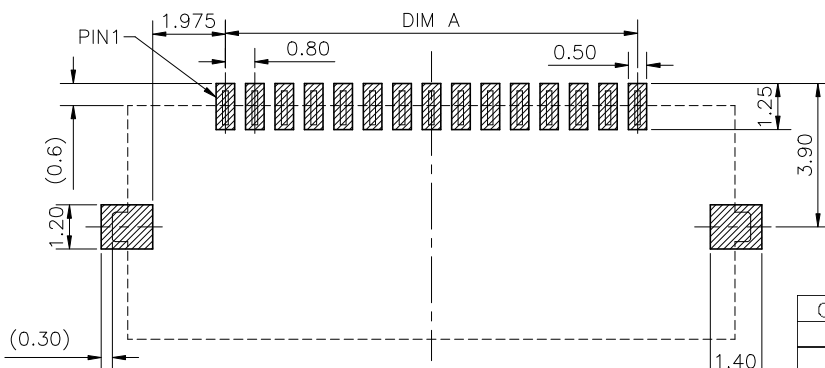
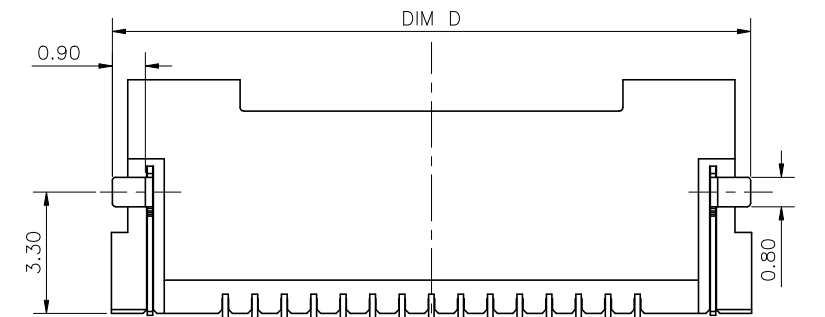

RECOMMENDED PCB LAYOUT
 GENERAL TOLERANCE ±0.05

CKT	DIM A	DIM B	DIM C	DIM D	DIM E
26	20.0	26.2	23.15	26.15	25.3
32	24.8	31.0	27.95	30.95	30.1
34	26.4	32.6	29.55	32.55	31.7
36	28.0	34.2	31.15	34.15	33.3

QUALITY SYMBOLS	DRAWN BY	DATE			
MAJOR Ⓢ	Xu,Bin	22/11/28			
CRITICAL Ⓢ	CHECKED BY	DATE	0.8mm PITCH EASY ON FPC SMT R/A B/C TYPE 1.6H		
GENERAL TOLERANCES (UNLESS SPECIFIED)	Xu,Zhi Yong	22/11/28			
X ±0.5	APPROVED BY	DATE	UNITS	SIZE	RFQ NO.
X ±0.25	Xu,Zhi Yong	22/11/28	mm	A4	N/A
.XX ±0.15			SCALE	SHEET NO.	REV
.XXX ±0.1			1:1	1 OF 1	C
ANGLES ±2°					DWG NO.
					52522-XXXX-XXX